



# INSTALLATION DRAWING

**ACO Pty Ltd**  
1300 765 226  
sales@acoaus.com.au

DRG #: IJ001

## BALCONYDRAIN, DOUBLE MEMBRANE, TILE FLOORING

www.acobuildline.com.au  
www.acobuildline.co.nz

**ACO Limited**  
0800 448 080  
sales@aconz.co.nz

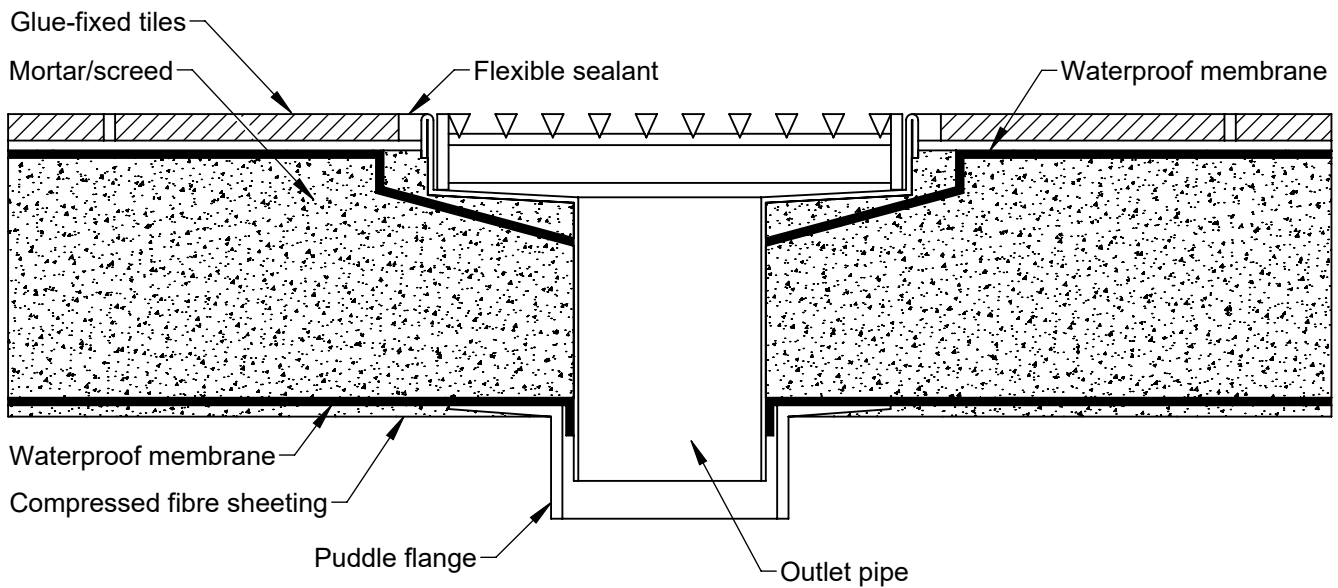

### NOTES:

1.. These details only provide a practical reference. ACO recommends designers and installers check local legislative standards and practices, or seek specialised engineering advice.

## Specification Clause

The floor channels are to be ACO BuildLine BalconyDrain, grade 304/316 stainless steel as supplied by ACO Pty Ltd. The grates are to be Linéaire/ Affiner /Tile/5 Star.

All components used within the scope of the systems are shown on drawing number/s \_\_\_\_\_. All work should be carried out strictly in accordance with the manufacturer's instructions and the installation details set out on drawing number/s \_\_\_\_\_.

The channels overall depth, length, outlet position and outlet diameter are specified on drawing number/s \_\_\_\_\_.

*\*Please delete or complete where appropriate*